

# Intimate Weddings at



## Punga Cove

ENDEAVOUR INLET  
MARLBOROUGH SOUNDS

DECEMBER 2020





# A stunning wedding venue...

---

Punga Cove offers an intimate wedding venue for up to 50 guests, including accommodation.

We offer a unique and personalised approach to planning and hosting your Punga Cove wedding, ensuring it is the perfect day you've always dreamed of.

With extraordinary views from many vantage points, waterfront jetty and beachfront, delicious food in our award-winning Punga Fern restaurant, well-appointed accommodation for up to 60 people and friendly staff, Punga Cove offers a truly unique Marlborough wedding experience.

The private setting gives you and your friends and family the chance to spend quality time together in a relaxing location.

## **Please note**

Dates for 2021 and 2022 are limited. Please check with Marlborough Weddings & Events for lodge availability.

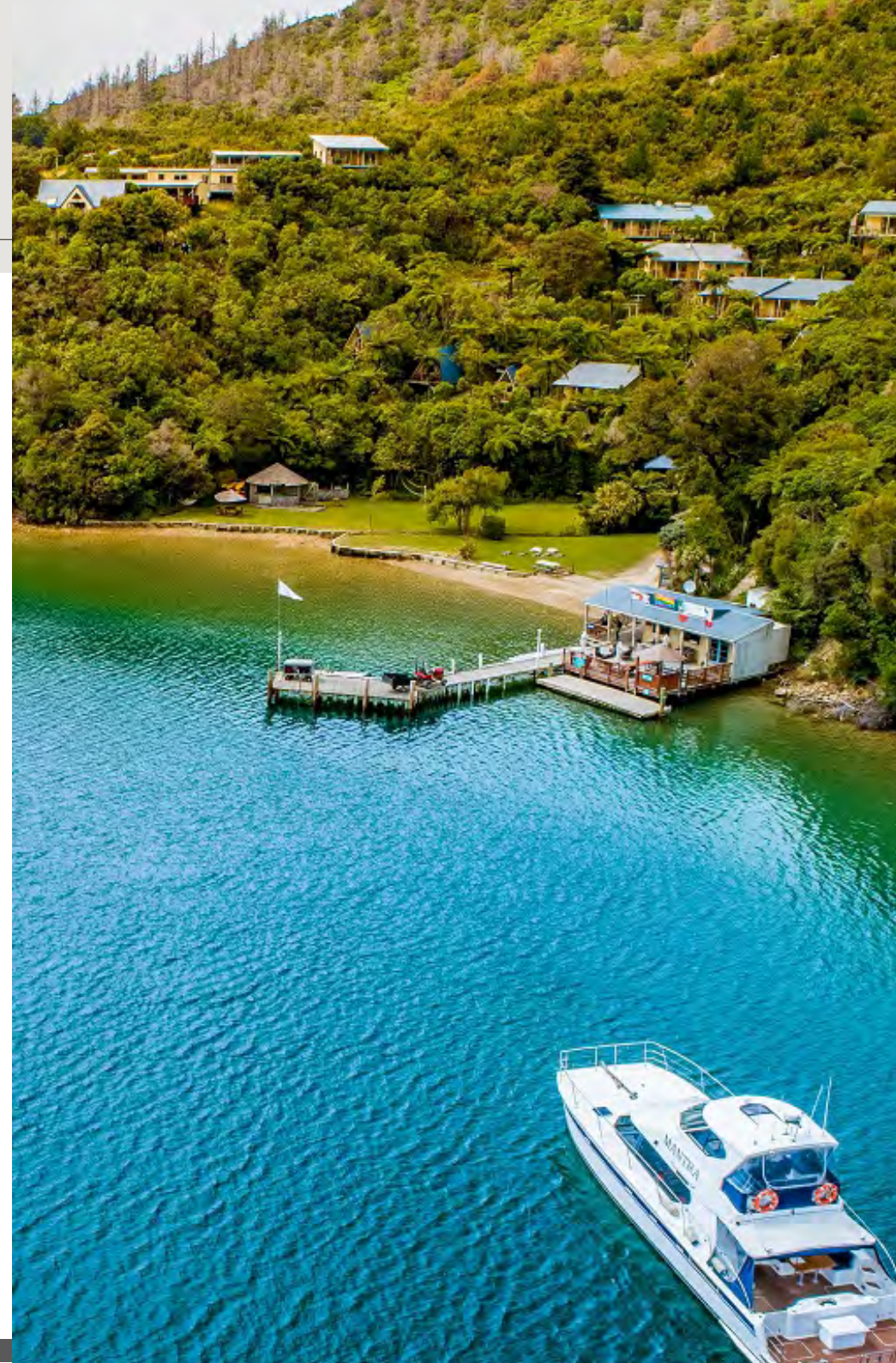



# A seamless experience

---

Punga Cove offers a seamless wedding experience where we take care of everything, while you relax and enjoy your special day.

We offer a full end-to-end wedding service, with everything you may require, including:

- A variety of stunning locations for your wedding service, photos and reception
- Gourmet cuisine, prepared on-site by our chefs in our restaurant kitchen, paired with wine and beer
- Sumptuous accommodation for up to 60 people onsite
- Land and water transportation
- Authentic guest activities exploring the local area
- A wedding planner, with extensive experience and options for photographer, flowers, cake, hair & makeup etc

See our packages for the different options we offer, or talk to us about customising your dream wedding.









## The service & photos

---

Most of our weddings take place on the waterfront lawn. There is also the option to hold it on the balcony or inside the Punga Fern Restaurant, or on the jetty.

There are many options for photos around the property and in the local area.

We have a list of experienced local photographers who know Punga well, and there are also many photographers from Nelson, Wellington and all over New Zealand who are happy to travel.



# The reception & menus

---

Whatever your style, your reception at Punga Cove will be a romantic affair.

Our award-winning Punga Fern Restaurant dining room has some of Marlborough's best views, to match the superb cuisine.

Our passion for food and local produce, and on-site chefs, means we can create an exciting wedding menu bespoke to your taste.

We offer many styles of dining that all work well with the venue, including:

- Grazing table
- Casual & fun food stations
- Seated & plated entrée, main & dessert

See below for sample menus and packages that include food, or talk to us about what you desire and we'll work with you to make it happen.





# Sample menus

---

Below are a range of sample menus, or you may wish to work with us on your own menu.

## Canapes

Smoked pumpkin arancini with parmesan (veg)

Sweetcorn croquettes, aged cheddar custard (veg)

Cranky Goat curd on seeded lavosh with beetroot relish (veg,GF)

Ora King Salmon gravlax blini with dill crème fraiche (GF available)

Smoked fish cakes with lemon mayo and petit herbs (GF)

Kingfish crudo with citrus and cultured cream (GF)

Ham and manchego croquettes, mustard aioli

Slow cooked lamb, Yorkshire puddings

Premium Game venison carpaccio, horseradish and juniper crostini (GF available)





# Sample menus (cont)

## 2-3 course menus

### Entrée

Roasted beetroot, Cranky Goat smoked curd, hazelnuts, rocket  
(veg, GF)

Gin cured Ora King Salmon, cucumber, tonic, marinated roe (GF)

Seared beef carpaccio, parmesan custard, salsa verde, Pinoli  
pinenuts (GF)

### Main

Smoked pumpkin risotto, Cranky Goat feta, almonds, petit herbs  
(veg, GF)

Butter poached Blue Cod, mussels, white beans, parsley, preserved  
lemon (GF)

Dry aged ribeye, beef cheek and potato pavè, shallot, black  
garlic jus (GF)

### Dessert

Dark chocolate tart, cultured cream, buckwheat, olive oil

Baked goat's cheese cake, seasonal fruit

Roasted pineapple, coconut, rum (vegan, GF)





## Sample menus (cont)

---

### Casual lunch

Our Boatshed Café & Bar can produce a casual lunch for the day after, including:

Sharing plates

Platters

Stone-baked pizza

Sweets





# Beverages

---

Our wine list is largely based on local Marlborough wines along with French Champagne, if required.

Beer is also local New Zealand beer, but we can supply international brands if you prefer.

Our stock is constantly evolving but we're happy to send you a beverage list on request.





# Accommodation

---

Punga Cove offers accommodation for up to 60 across a range of room types.

Fronde Suites	5 suites	(max 2 people)
Mamaku Apartments	4 apartments	(max 4 people)
Fern Studios	2 studios	(max 2 people)
Koru Chalets	5 chalets	(max 2 people)

There are also single, double and twin/bunk rooms – back-packer style - with shared bathroom, sleeping up to 20 additional people.

This takes Punga Cove's full accommodation capacity to 60.

Guests can also be accommodated at our nearby sister lodge, Furneaux Lodge.





# Frond Suites

- 5 available
- One-bedroom suites
- 42-48sqm
- Max 2 guests
- King split beds – king or twin option (plus rollaway & cot options)
- Ensuite bathroom with shower
- Mini fridge with tea & coffee making facilities
- Air conditioning/heat pump
- Deck with water views

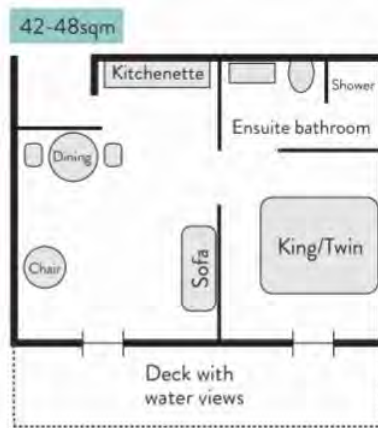



# Mamaku Apartments

- 4 available
- A range of multi-bedroom apartments, of different configurations, each with a deck with water views, mini fridge and tea/coffee making facilities. Rollaway bed & cot available.

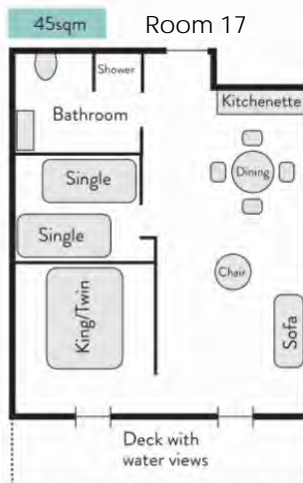
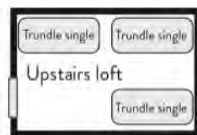
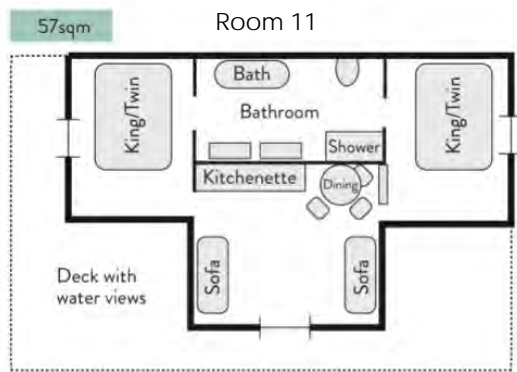
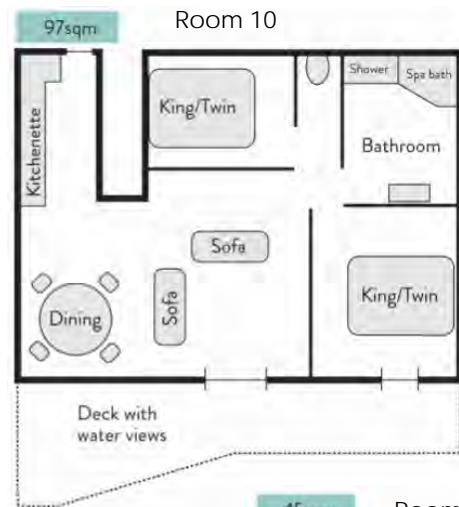
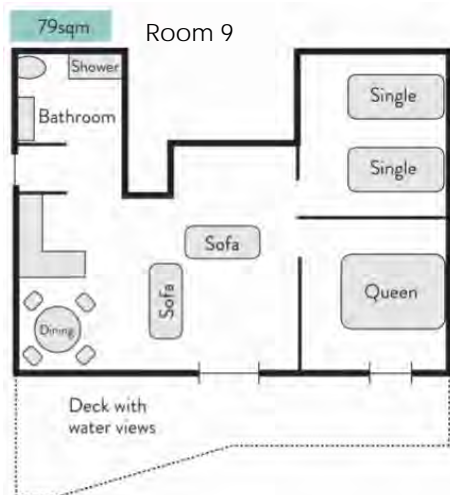



# Fern Studios

- 2 available
- Studio
- 31 sqm
- Max 2 guests
- King split beds – king or twin options (plus, rollaway bed & cot options)
- Ensuite bathroom with shower
- Air conditioning/heat pump
- Mini fridge & tea/coffee making facilities
- Deck with water views





# Koru Chalet Studios

- 5 available
- One-bedroom suites
- 42-48sqm
- Max 2 guests
- King split beds – king or twin option (plus rollaway & cot options)
- Ensuite bathroom with shower
- Mini fridge with tea & coffee making facilities
- Air conditioning/heat pump
- Deck with water views

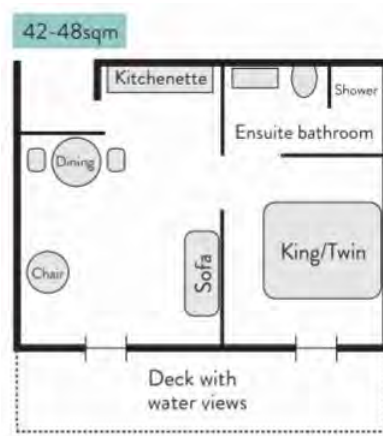



# Water transportation

---

Punga Cove is in the stunning Marlborough Sounds and getting here requires water transport from Picton.

Punga Cove is owned by the MTC Group which comprises Cougar Line and Marlborough Tour Company so we can offer you and your guests a number of ways to get to/from Punga Cove by water, and to enjoy the Marlborough Sounds while you're here.

This includes scheduled water taxi services, charter water taxi cruises and charter scenic and seafood cruises. Read on for schedules and pricing.

## Getting to Picton

To get to Picton you can fly direct from Wellington on Sounds Air, or to Marlborough Airport in Blenheim from Auckland and Wellington where it's a 30 minute drive to Picton.

Other ways of getting to Picton include driving from Christchurch, Nelson and the West Coast. Or getting a ferry from Wellington.

Marlborough Tour Company owns a fleet of buses for land transport from Blenheim or Nelson to Picton, or other locations.





# Authentic guest activities

---

There is plenty to keep you and your guests entertained over your wedding break.

Onsite – free of charge:

- Kayaks
- Paddle boards (SUPs)
- Pool & spa
- Walk to glow worms or Eatwells Lookout

Offsite, a range of land and water-based activities allow you and your guests to explore the local area, including:

- Guided walks or mountain biking on the Queen Charlotte Track
- Guided kayaking
- Private twilight cruise, seafood cruise or a social scenic cruise for all of your wedding guests to mix and mingle
- Luxury cruise – enjoy the stunning Marlborough Sounds aboard MV Tarquin, with your own private chef and crew
- Walk along the Queen Charlotte Track to our sister lodge for a delicious meal, with boat transfer back to Punga Cove

Offsite options will incur additional charges and we can quote on all activities for all group sizes.

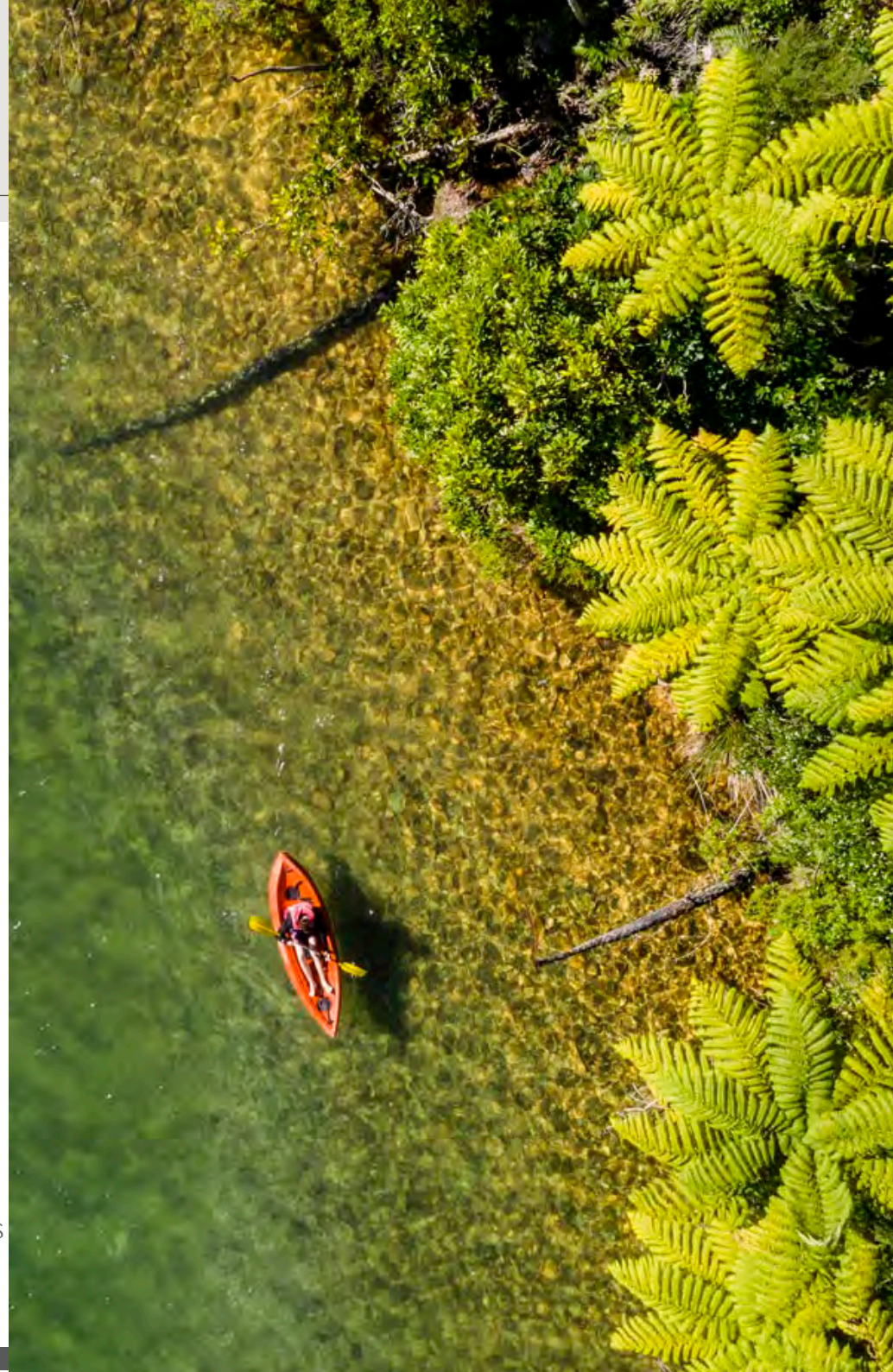



# Our wedding planner

Roxy and her team at Marlborough Weddings and Events are on-hand to help make your dream wedding an organised, stress-free event, while set in the beautiful surrounds of nature.

Incorporated in your function booking is 40 hours of wedding planning and event management with Marlborough Weddings and Events, who will be a huge role in your wedding celebrations as your biggest support system.

Roxy and her team will work alongside Punga Cove to help you with menus, bar items, transport, set-up and decorations.

Marlborough Weddings and Events is also available for additional wedding planning, and has upgrade packages for additional table dressing and hireage of other items to truly personalise your ceremony and reception.

Call Roxy now to start the process to having the most magical day in one of New Zealand's most beautiful locations – [marlboroughweddings@gmail.com](mailto:marlboroughweddings@gmail.com) or 027 357 8877

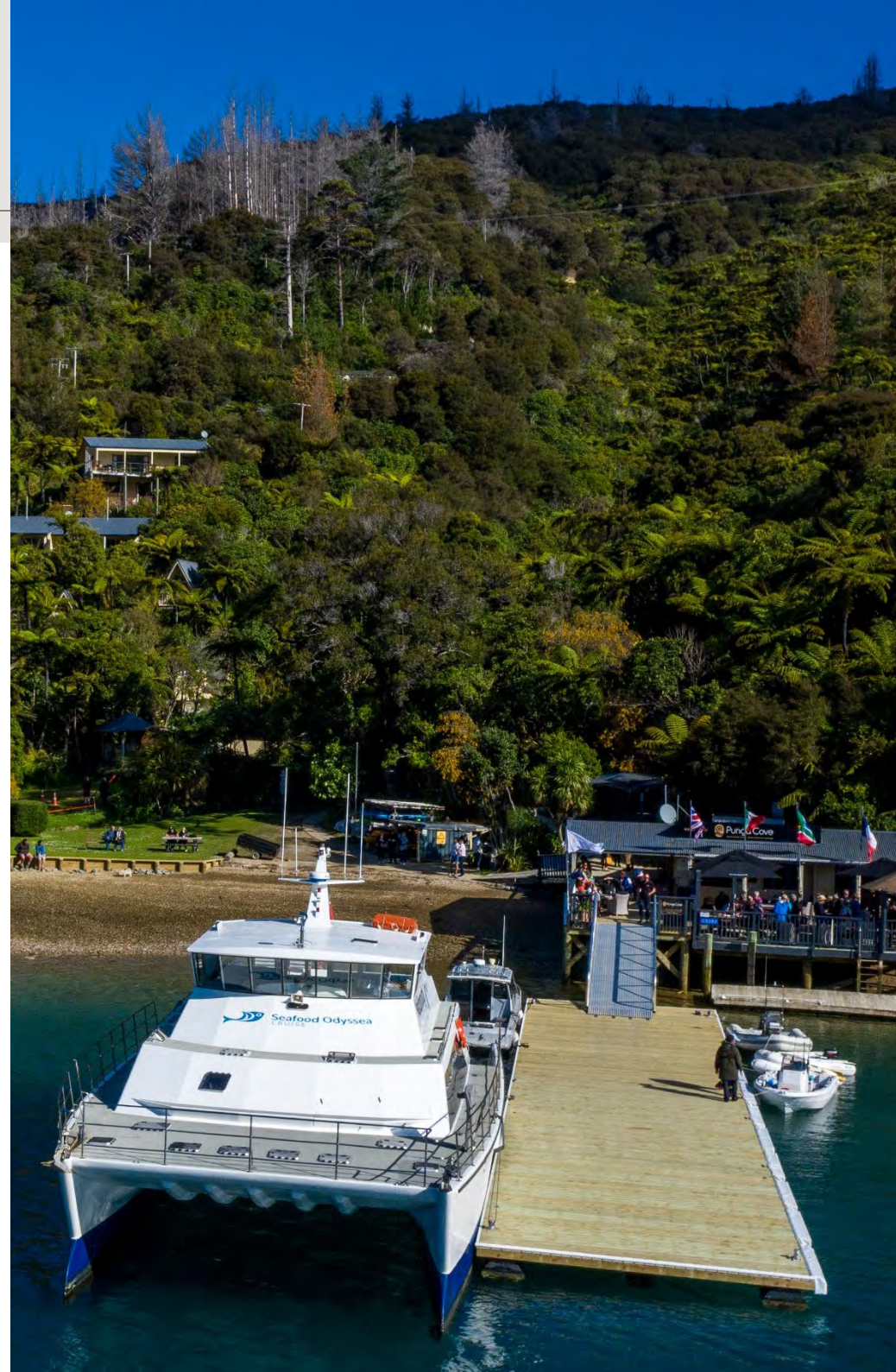







# Wedding packages

---

Depending on the size of your wedding party, we have several Punga Cove wedding packages for you to consider, or we can create one unique to you and your special day.

All packages include event fee, venue hire, food, tables, chairs, cutlery, crockery, wait and bar staff, and wedding planner.

Package prices exclude: GST, water transportation, accommodation, beverages and guest activities. These are an additional charge, outlined on the following pages.

## **Lodge exclusivity**

While wedding parties booking out all accommodation at Punga Cove may offer a level of exclusivity, it is possible that visitors will arrive during the course of the day -- due to the nature of the lodge being on the Queen Charlotte Track and the foreshore being publicly accessible.



# Accommodation prices

Punga Cove accommodation rates are for two people double or twin share and include: bed linen & towels | bathroom facilities | tea & coffee facilities | Wi-Fi use – generally available in the main lodge | New Zealand Goods & Services Tax (GST)

	Avail	Max pax	Room size	Bedrooms/ beds	Off peak 1 May - 31 Oct 2021 1 May – 31 Oct 2022	Peak 1 Nov – 21 Dec 2020 11 Jan – 30 Apr 2021 1 Nov – 21 Dec 2021 16 Jan – 30 Apr 2022	Premium 22 Dec 2020 – 10 Jan 2021 22 Dec 2021 – 15 Jan 2022
<b><i>Fronde Suite</i></b>	5	2	42-48 sqm	1 bedroom: King/Twin	\$240	\$370	\$390
<b><i>Mamaku Apartment</i></b>	4	4-5	45-97 sqm	2-3 bedroom: King/Twin + singles	\$220	\$340	\$375
<b><i>Fern Studio</i></b>	2	2	31 sqm	Studio: King/Twin	\$220	\$340	\$375
<b><i>Koru Chalet</i></b>	5	2	22 sqm	Studio: Queen	\$180	\$260	\$280
<b><i>Basecamp Ensuite</i></b>	1	2-3		Studio: Queen + single Own ensuite	\$120	\$180	\$200
<b><i>Basecamp Double / Twin / Bunks</i></b>	6	2		3 x double / 1 x twin / 2 x bunks. Shared bathroom	\$100	\$140	\$155
<b><i>Basecamp single*</i></b>	6	1		Single bed in own cabin. Shared bathroom	\$60	\$75	\$85

\*Rate is for 1 person.



# Water transport prices

Cougar Line operates a daily water transfer service throughout Queen Charlotte Sounds/Totaranui every day of the year except Christmas Day.

Check in half an hour prior to departure at Picton Office on the town wharf | Price includes water transfer plus luggage, and GST (New Zealand Goods & Services Tax)

	Season	Depart Picton	Arrive/ Depart Punga approx	Return Picton approx	Price per adult return	Price per child* return
<b><i>Cougar Line Scheduled Water Transfers</i></b>	May- Sept	9am	10.30am	12pm	\$90	\$50
		1.30pm	3pm	4.30pm		
	Oct- Apr	8am	9.30am	11.30am	\$90	\$50
		10am	11.30am	1pm		
		1.30pm	3pm	4.30pm		
		6pm**	7pm**	9pm**		

\*For children aged 5-15 years, 0-4 years are free.

\*\* Every Friday during October & November, daily December – April.

Enquire about charter water transport with Cougar Line, or charter a Marlborough Tour Company launch for a scenic seafood cruise to/from Punga Cove as a transfer, or as a day trip from the lodge.



# Private vessel charters

---

We have a range of private charter vessels available for transport and cruise options.

## **MV Odyssea**

20 metre catamaran | 90 people max for cruises or 70 for meals

## **MV Mantra**

14 metre catamaran | 25 people max

## **MV Tarquin**

20 metre luxury launch | 20 people max/day or 6 max overnight

## **Sounds Adventure**

17 metre monohull | 110 people max

## **Sounds Discovery**

11 metre catamaran | 40 people max





# Exclusions

---

The following dates are unavailable for weddings due to high demand:

## January

1-10 January

Nelson Anniversary Weekend

## February

Waitangi Weekend

## March/April

Easter Weekend

April school holidays

## June

Queen's Birthday Weekend

## July

School holidays

## September

School holidays

## October

School holidays

Labour Day weekend

Marlborough Anniversary weekend

## November

Canterbury Anniversary weekend

## December

Last 10 days of December, including Christmas Day and Boxing Day





# Terms

## Wedding function bookings:

- \$3,000 non-refundable deposit
- Payment in full 60 days prior to the wedding date.

## Wedding function cancellation policy:

30+ days prior to wedding	Loss of deposit
7-30 days prior to wedding	50% function charge
1-6 days prior to wedding	100% function charge

## Wedding accommodation:

- Rooms can be held for 10 days at no charge.
- 25% deposit on rooms booked at the time of reservation.
- Remainder on check-in, or earlier by arrangement.

## Changes to accommodation bookings (e.g. number of rooms):

30+ days prior to arrival	No charge
7-30 days prior to arrival	Free transfer to another date within a 12-month period, or 50% tariff charge
1-6 days prior to arrival	100% tariff charge





## Terms (cont'd)

---

### Cancellations due to Government-imposed travel bans

If your travel plans are interrupted due to Government-imposed travel bans or border closures, you are welcome to transfer your booking to a later date within the next 12 months with no transfer fee.

Depending on room type availability and intended travel season, differences in room rate or room type may apply as at the date of rebooking. Otherwise our standard cancellation policy applies.

### Cancellations by Punga Cove and Marlborough Tour Company

Punga Cove and Marlborough Tour Company reserve the right to reschedule or cancel any tours, cruises and accommodation booked if it feels that they cannot be undertaken safely, e.g. bad weather conditions.

In the event of Punga Cove or Marlborough Tour Company making a cancellation you will be offered an alternate date or option, or receive a full refund.

All transactions are in New Zealand dollars at the time of making a booking and at the time of making a cancellation; Punga Cove and Marlborough Tour Company cannot accept any liability for fluctuation in exchange rates between these transactions taking place.





# Banking details

---

## Punga Cove

Bank account  
Marlborough Tour Company  
ANZ Bank  
06-0601-0742421-01

Swift code  
ANZBNZ22

GST number  
057-785-081

Punga Cove accounts contact  
[accounts@marlboroughtourcompany.co.nz](mailto:accounts@marlboroughtourcompany.co.nz)





# Contact details

---

We would love to hear from you and to talk more about what your vision is for your special day.

## Physical Address

Endeavour Inlet, Queen Charlotte Sound, Marlborough Sounds

## Postal Address

PO Box 1000, Blenheim, Marlborough, New Zealand

## Phone

+64 3 579 8561

## Web

[www.pungacove.co.nz](http://www.pungacove.co.nz)

## Wedding-related email

Roxanne Phipps - [marlboroughweddings@gmail.com](mailto:marlboroughweddings@gmail.com)

## Lodge-related email

[trade@pungacove.co.nz](mailto:trade@pungacove.co.nz)





